



Rotary Information Technology GEMS



GEMS - DACdb

Log Ins

DACdb.com - Sign into the database work area
m.DACdb.com - Sign into the mobile web page

GEMS - DACdb

- ❖ Logging in: **Don't know your club number?** Sign in without the club number first. Select the "My Club" tab. When the screen opens you will see the number here. Then, after you have the number, log out, and log back in again including your club number

Gwinnett County Club Members (Club# 4166)

All Club members are listed under one of the three tabs below based on their MemberTypes or Terminated status.
 Club Leaders can be added (or removed) to this display, by turning them on using the configure ICON at the top right and the "Show Club Officers" to Yes (or No).

2018-19 Club Officers

Mark Willis <i>President</i>	Jennifer S. Hibbard <i>President-Elect Training Officer</i>	Laine Nowell <i>2018 Club On-To-G Secretary</i>

GEMS - DACdb

Use the latest user interface. It should look like this after you select the "My Club" tab:

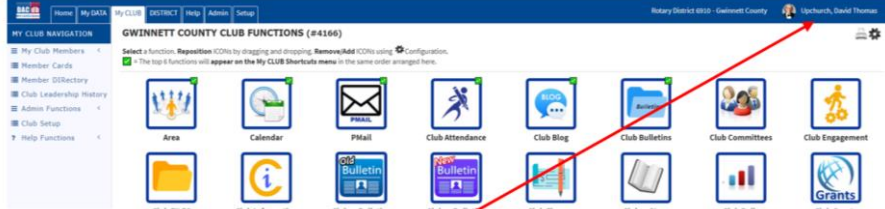

If you do not see these icons, look in the upper corner for your name and select "switch to new interface"

GEMS - DACdb

Be sure DACdb recognizes your privilege level (club officers are 4). Click your name in the right upper corner of the screen and you will see this dropdown (if you don't enter your club number in at login, the number will be "1" instead of "4" and you will not see information limited to club officers)



The number by 6910- is your privilege level

Lined area for notes, consisting of multiple horizontal lines.

GEMS - DACdb

Mobile DACdb for the Smart Phone
Rotary in Your Pocket or Purse

Probably the Most Useful Feature for Most Rotarians
m.dacdb.com in your browser (it is not an ap)
Do not enter www!!
Use the same log in

GEMS – MY ROTARY

My Rotary is the "Rotarians Only" area of www.rotary.org. Content in My Rotary is highly role specific. If RI does not recognize your office role, you will not see content designed for club officers. *Content will not be just grayed out. It will not be there at all.* So, it is crucial to check your assigned role in My Rotary at the beginning of each year or any time you cannot see features that you think you should.

GEMS – MY ROTARY

❖ **Member Center:** After "Member Center" is selected, the most important dropdown will be "Online tools"

The screenshot shows a dropdown menu with the following items: "Online tools", "Rotary Club Central", "Brand Center", "Rotary Showcase", "Rotary Ideas", "Learning Center", and "Discussion Groups". Two red arrows point from text boxes to "Rotary Club Central" and "Rotary Showcase". The text boxes contain the following instructions:

- Click "Rotary Club Central" to go to the most important RI work area (see the next page for more on RCC)
- Click Rotary Showcase to see an incredible list of Rotary services and fundraising projects (there are 16 from District 6910)

GEMS – MY ROTARY

For Help at RI (Especially with difficult membership issues such as duplicate RI numbers): Go to DACdb or m.dacdb.com then select District then Committees. Scan down to “Zone 34 and RI”, Look for RI service staff members Marni Nixon or Alicia [Pijal-Avila](#).

<http://m.dacdb.com>

You can open on MAC , PC or
Smartphone
